

TWIN CELL SOLAR MODULES SERIES WITH

20.7% EFFICIENCY.

DESIGNED TO MAXIMIZE POWER AND PERFORMANCE OVER GENERATIONS.



With this technology customer can boost their energy yield by generating the same power with fewer modules, or through generating higher system yield form the same surface area.

Twin cell series module are most effective and ideal choice where the space is limited and where the temperature are higher.

MORE POWER



Low power loss in cell connection



Better shading tolerance



Low NMOT: 42 ± 3 °C

Low Temperature Coefficient (Pmax): $-0.36\% / ^\circ\text{C}$

MORE RELIABLE



Lower hot spot temprature



Minimizes micro-cracks



Heavy snow load up to 5400 pa,
wind load up to 3600 Pa*

FLOW OF ELECTRICITY IN TWIN CELL SERIES SOLAR MODULES.

The twin sections reduce internal resistance and ensure continued production of energy when partially shaded.

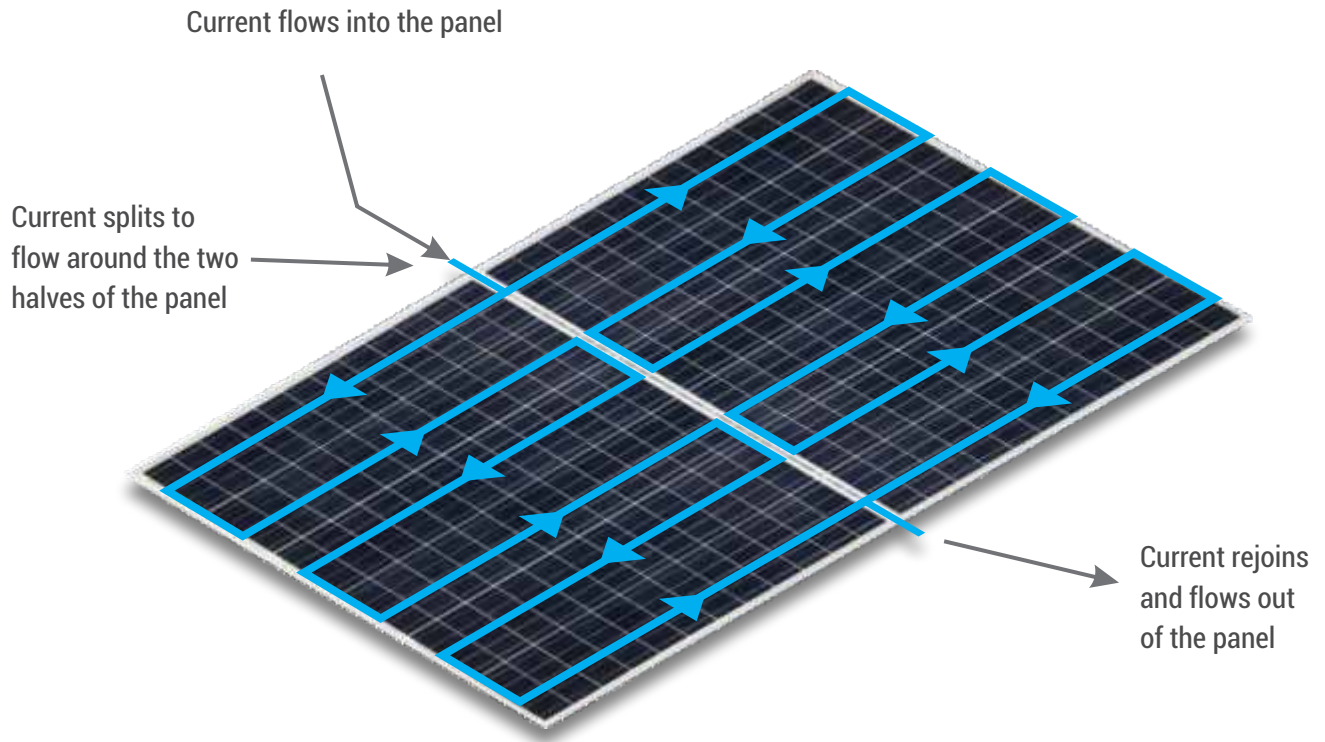

25 YEARS WARRANTY

- Novergy warranty
- Standard Warranty

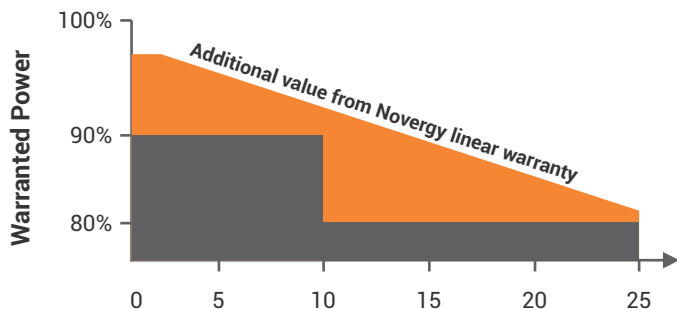

10 YEARS PRODUCT WARRANTY ON MATERIALS AND WORKMANSHIP

PERC SOLAR CELL*

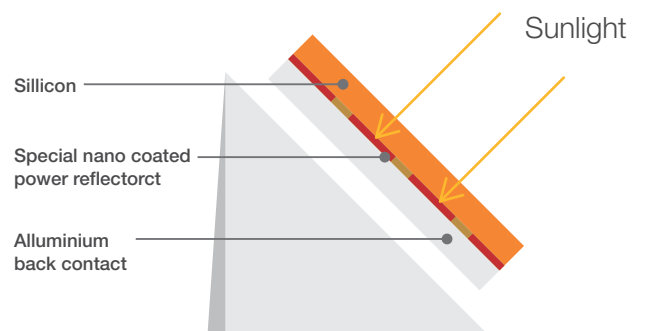



POLY PERC TWIN CELL SERIES

(72 Full Cells)

PCAL-TC-Series

Model	PCAL-335	PCAL-340	PCAL-345	PCAL-350	PCAL-355	PCAL-360
Type of cells	Poly Crystalline					
Numbers of cells	72 (Twin Cell)					
Wattage (Wp)	335	340	345	350	355	360
Voltage at max.power (Vmax)	38.2	38.4	38.6	39.2	39.4	39.6
Open Circuit Voltage (Voc)	45.7	45.9	46.1	46.6	46.8	47
Current at maximum power (Imax)	8.77	8.86	8.94	8.94	9.01	9.09
Short circuit current (Isc)	9.28	9.36	9.44	9.51	9.58	9.66
Frame	Anodized Aluminium Alloy					
Front Glass	Tempered 3.2 mm (Low iron solar glass)					
Junction Box	IP 68					
Cable	4 mm ² PV cable					
Connector	MC4 Series					
Number of Diode	3					
Dimensions (mm)	1997 x 992 x 40 mm					
Max Series fuse rating	30 A					
Weight (Kg)	22.5					
Operating temperature (Deg.C)	-40° C to + 85° C					
Application Class	Class A					
Maximum System Voltage	1500 VDC					
Temp. Coefficient's	Power = 0.36%/°C Voltage = - 0.31%/°C Current = +0.05%/°C					
NOCT	43 +/- 3°C					
Maximum Load	5400 Pa					

Rear View

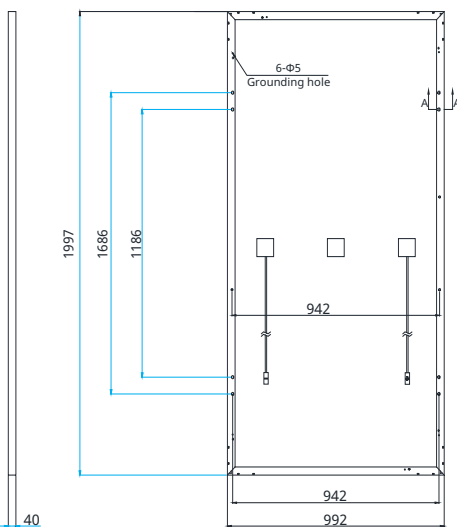

Frame Cross Section A-A

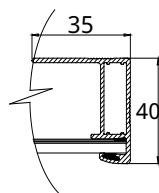

Mounting Hole

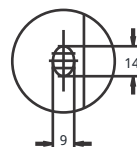

Current (A)

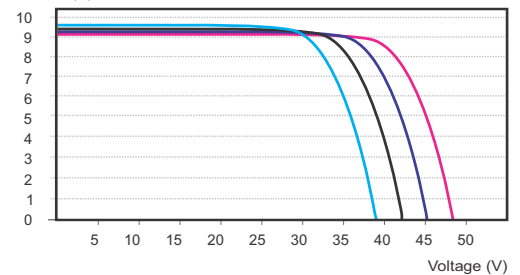

Current (A)

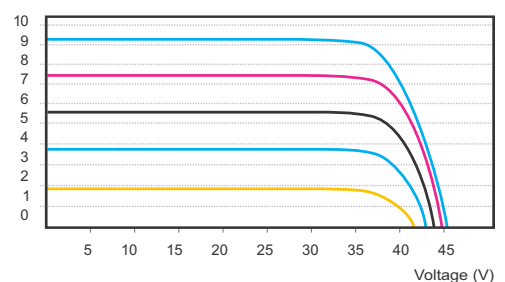

Specifications are subject to change without prior notice.



MONO PERC TWIN CELL SERIES

(72 Full Cells)

MCAL-TC-Series

Model	MCAL-375	MCAL-380	MCAL-385	MCAL-390	MCAL-395	MCAL-400	MCAL-405	MCAL-415
Type of cells	Mono Crystalline (PERC)							
Numbers of cells	72 (Twin Cell)							
Wattage (Wp)	375	380	385	390	395	400	405	415
Voltage at max.power (Vmax)	39.8	40.0	40.2	40.4	40.6	40.8	41.0	41.2
Open Circuit Voltage (Voc)	47.6	47.8	48.0	48.2	48.4	48.6	48.8	49.0
Current at maximum power (Imax)	9.43	9.50	9.58	9.66	9.73	9.80	9.88	10.07
Short circuit current (Isc)	9.93	10.01	10.09	10.17	10.25	10.33	10.41	10.50
Frame	Anodized Aluminium Alloy							
Front Glass	Tempered 3.2 mm (Low iron solar glass)							
Junction Box	IP 68							
Cable	4 mm ² PV cable							
Connector	MC4 Series							
Number of Diode	3							
Dimensions (mm)	2038 x 1000 x 40 mm							
Max Series fuse rating	30 A							
Weight (Kg)	22.5							
Operating temperature (Deg.C)	-40°C to + 85°C							
Application Class	Class A							
Maximum System Voltage	1500 VDC							
Temp. Coefficient's	Power = 0.36%/°C Voltage = - 0.29% /°C Current = +0.05% /°C							
NOCT	43 +/- 3° C							
Maximum Load	5400 Pa							

Rear View

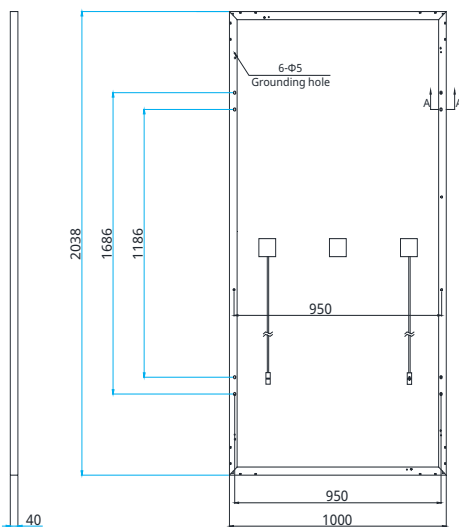

Frame Cross Section A-A

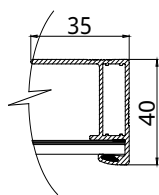

Mounting Hole

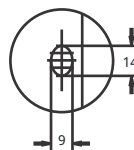

Current (A)

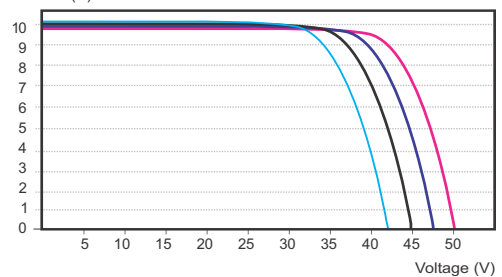

Current (A)

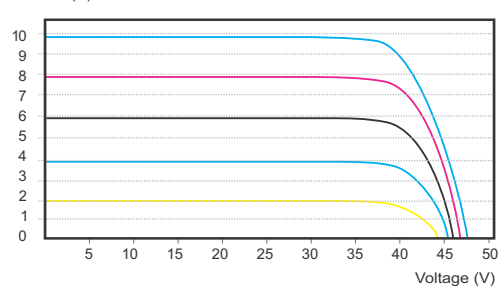

Specifications are subject to change without prior notice.

**To Get more Power and Greater Returns,
Contact Novergy Today!**

Write to enquiry@novergy.net
Visit us at novergysolar.com